

Tower B
Ground Floor Plan - 21,712 sq. ft.

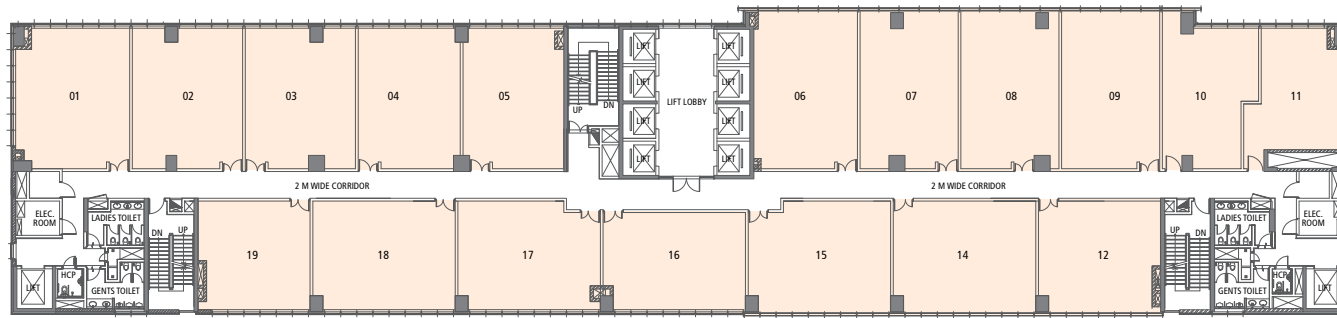

Tower B
Typical Floor Plan - 26,165 sq. ft.

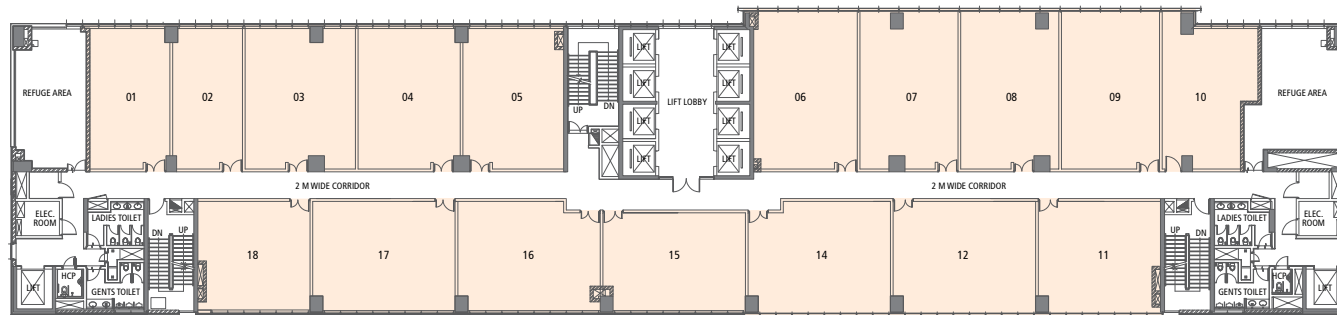

Tower B
Typical Floor Plan with Refuge - 23,957 sq. ft.

In the interest of maintaining high standards, all floor plans, layout plans, areas, dimensions and specifications are indicative and are subject to change as decided by the company or by any competent authority. Soft furnishing, cupboards, furniture and gadgets are not part of the offering. 1 sq. mtr. = 1.196 sq. yds. & 1 sq. mtr. = 10.76 sq. ft.



DIGITAL GREENS
 GURGAON